

[Your Name Here]
Infinite Pittsburgh Trivia

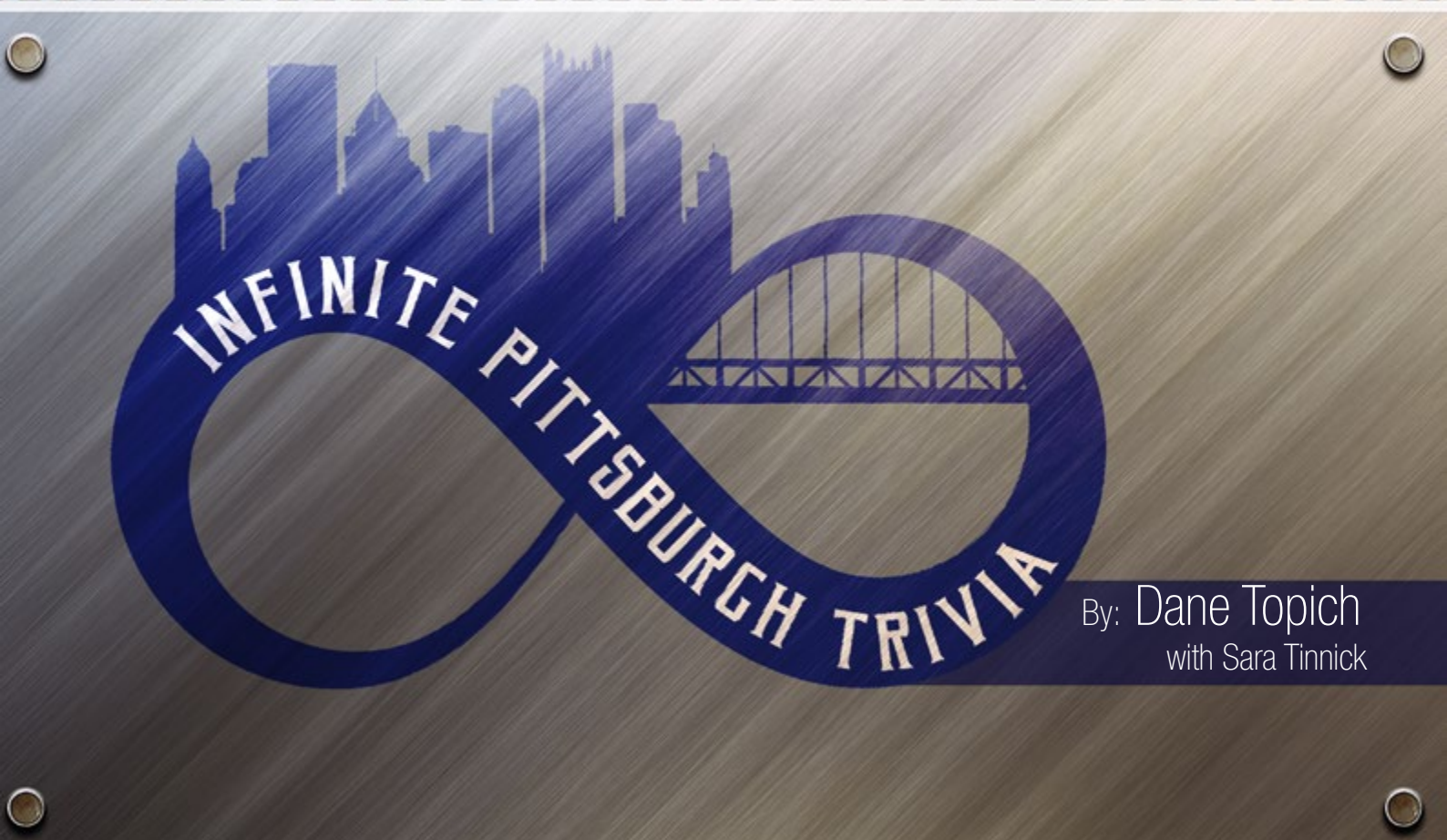

By: Dane Topich
with Sara Tinnick

PROPOSAL: PUBLICATION OF eBook

Attached are examples illustrative of the format, variety, and comprehensiveness of topics and questions in a potential eBook.

It's **“INFINITE PITTSBURGH TRIVIA”** because the questions can be endless.

Have a question?

Send us the question and possible answer. If we can verify the material, we will put it in the book and acknowledge your contribution!

If you have a photo to complement your question or a question already in the book, send it, too.



Table of Contents

- Celebrities from the Start
- Art, Culture, Education, & Entertainment
- Music
- Art & Architecture
- Museums
- Theater & Theaters
- Movies
- The Written Word
- Libraries
- Colleges & Universities
- Flora, Fauna, & the Great Outdoors
- The Miscellaneous & The Merely Strange
- Money, Money, Money
- Places of Interest
- People & Personalities
- On Air: Part I
- On Air: Part II: The Voices of Sports
- In Print
- People from the Past
- Slogans for Sale
- The Lay of the Land
- Getting from Here to There
- Food (& Drink) for Thought
- Pucks, Balls, Bats, Jocks, Ponies, & All That Other Stuff
- Baseball
- Basketball
- Football: Pro
- Football: High School
- Football: College
- Golf
- Hockey
- Bait 'N Bullets
- Government & Politics
- Who We Are and How We Live
- Business in the 'Burgh
- Beyond the 'Burgh



The Pittsburgh skyline reflecting in the Allegheny River at night, seen from the North Shore, in Pittsburgh, Pennsylvania. — Photo by appalachian view

CELEBRITIES FROM THE START

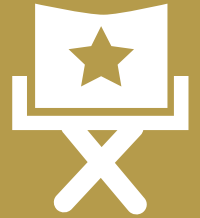

He was born nearby in Indiana, Pennsylvania. He married Gloria. He traveled to Washington under a very common fictitious name. His work is on view regularly during the Christmas season. He is a retired Air Force General. Who is he?

Jimmy Stewart.

Indiana, PA now has a museum featuring much of his memorabilia.

Which famous area actor at one time worked as a stagehand at WQED-TV?

Michael Keaton. Keaton was born in Coraopolis, PA and graduated from Montour High School in 1969. He did his stagehand work without a mask or cape.

Because of his prowess, to say nothing of his propensity, Jackson, a bull elephant at the Pittsburgh Zoo and Aquarium, gets to leave his home periodically to go to work. What is his job, his avocation really? (Hint: his job requires only two of his feet to be on the ground.)

Jackson, who weighs 10,400 pounds, is only one of two elephants in the U.S. (the only one in a zoo) who breeds naturally (as opposed to artificial insemination). Thus far, Jackson has sired six offspring, with more on the way. By the way, the gestation period for an elephant is about 22 months.



Why is Jackson smiling?

Courtesy Pittsburgh Zoo and PPG Aquarium.

ART, CULTURE, EDUCATION & ENTERTAINMENT



MUSEUMS

What is the name of the large dinosaur on the prowl in front of the Carnegie Museum on Forbes Avenue in Oakland and how big is he?

The dinosaur's name is "Dippy" and he is patterned after Diplodocus Carnegii. Dippy is 85 feet in length and 18 feet high. Carnegie paleontologists found this specimen first. Its replica is now in museums all over the world, especially in Europe. Andrew Carnegie gave the first replica to the King of England in 1905, already put together, too. The rather oddly costumed small model of a Tyrannosaurus Rex nearby is the result of a local fundraiser.



MUSIC

What was the name of the barge owned by the American Wind Symphony that sailed on Pittsburgh's waterways and docked to play symphonic music at local river towns?

Point Counterpoint II. The vessel sailed over 400,000 miles at an average speed of 6 mph, even going as far as Saint Petersburg, Russia. It went into dry-dock in 1996.

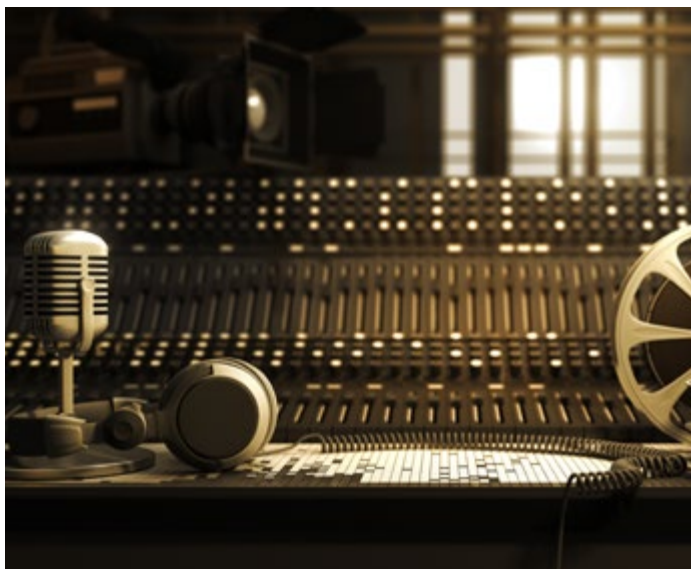
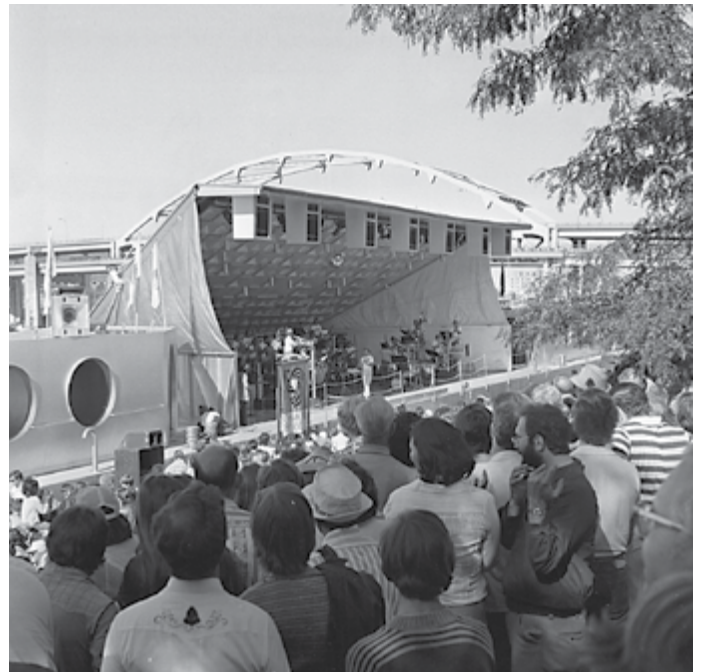

MUSIC



How many appearances did the Beatles make in Pittsburgh?

Only One! September 14, 1964. They performed at the Civic Arena.

ART & ARCHITECTURE

The Frank Lloyd Wright-designed Fallingwater in Fayette County has an international reputation. About ten miles from Fallingwater is another Wright home.

What is its name?

Kentuck Knob. This less well-known Wright home was completed in 1956 for the I. N. Hagan family, Uniontown ice cream manufacturers. Kentuck Knob is now owned by Londoner Lord Peter Palumbo and is open to the public.



View of southeast porch at Kentuck Knob in Chalk Hill, PA. Designed by Frank Lloyd Wright for I. N. and Bernardine Hagan, it was completed in 1956. Photo by Jack E. Boucher, 1986, for the Historic American Building Survey. Library of Congress, HABS PA, 26-Chalk, 12.



ART & ARCHITECTURE

There is more to Market Square than pigeons. On a building facing the Square and Forbes Avenue is a large mural and collage, Regional Patterns.

What materials make up the artwork and what does the art portray?

The place has 20 restored molds used to make steel at USX's Duquesne Works. The molds represent the three rivers. Four panels on the piece simulate the quadrants of Market Square. Christopher Siefert and Yaming Di, graduates of CMU's art school, designed the mural. It was financed by various local foundations, corporations, and private sources.

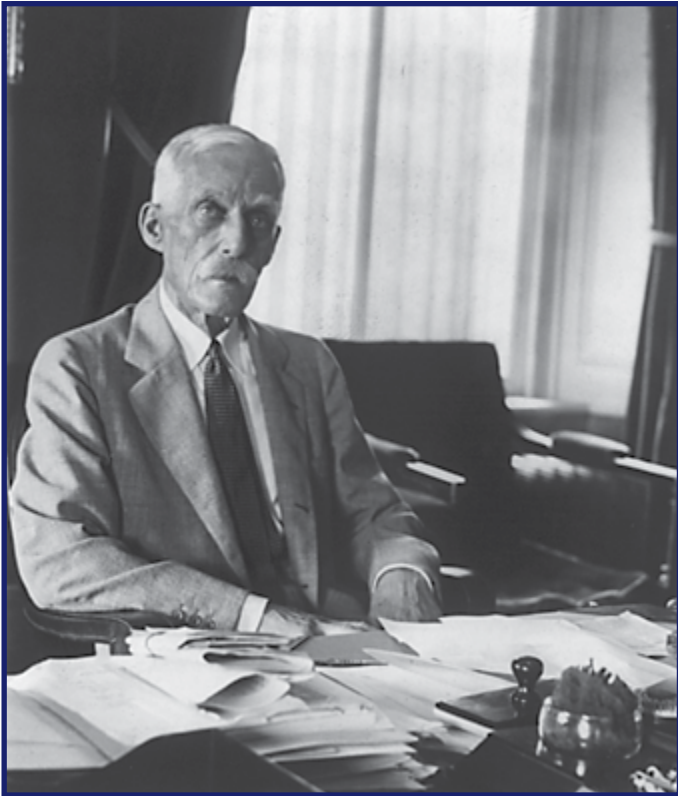

MUSEUMS

Which ex-Pittsburghers as a family are the largest benefactors of the Washington, DC National Gallery of Art?

Andrew W. Mellon, and his children, Alisa Mellon Bruce, and Paul Mellon. They are considered founding benefactors.

Andrew W. Mellon, Secretary of the Treasury, in his Washington, DC office on June 14, 1929. National Photo Company Collection, Herbert E. French, Library of Congress, LC-USZ62-52418.

Tennessee Williams is gone, but where can you evoke his memory by riding A Streetcar Named Desire?

At the Pennsylvania Trolley Museum in Washington, PA. In 1964, the museum bought the trolley from the City of New Orleans for one dollar when it became available. One reason it's here is because New Orleans and Pittsburgh are the only two cities in the U.S. that have a track gauge of five feet two and a half inches. (The gauge is the distance between the rails). New Orleans stopped running the Desire in 1948.



A bit of Tennessee (Williams) near Pittsburgh. Photo by Scott R. Becker. Courtesy of the Pennsylvania Trolley Museum.

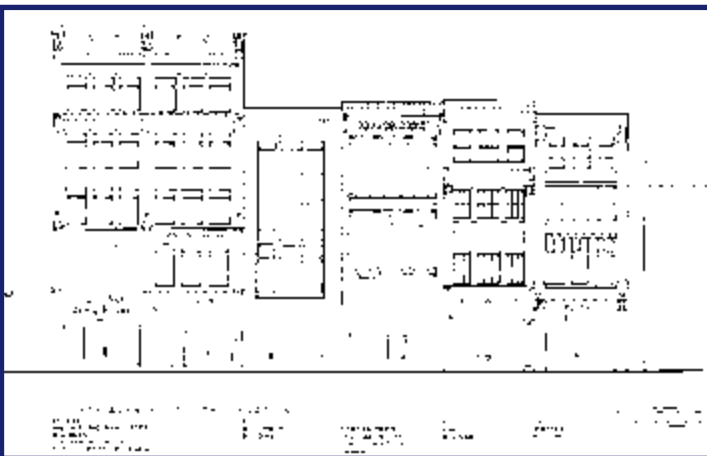

631-633 Liberty Avenue. Library of Congress, Historic American Buildings Survey, John A. Bertola, delineator, 1984. HABS PA, 2-PITBU, 40.



THEATER & THEATERS

Heinz Hall and the Benedum Center were movie theaters before they were renovated. What were the names of these theaters?

Heinz Hall was the Penn Theatre and the Benedum was the Stanley Theatre.



THEATER & THEATERS

The building now housing the Byham Theater on Sixth Street was what kind of a theater when it opened on Halloween night in 1904?

The Gayety Theater staged live vaudeville and “refined burlesque” productions. The building became a movie theater, the Fulton, in 1930. The Byham opened in 1995.



THE WRITTEN WORD

Does Harry Potter have a Pittsburgh area ancestor?

With a little imagination the answer is yes. The Harry Potter series is published in the United States by Scholastic. On October 22, 1920 M. R. “Robbie” Robinson started the Scholastic Publishing Company in his hometown of Wilkinsburg, Pennsylvania. Today the company, now in New York and headed by the founder’s son, has sales of over \$2 billion and publishes over 35 classroom magazines with a circulation of about 35 million students in grades K-12, plus 40 million parents.

Which Pittsburgh-born author received the Pulitzer Prize for Biography in 1993?

David McCullough. It was for Truman. McCullough also received a Pulitzer in 2002 for John Adams.



MOVIES

Actor Paul Newman starred in a 1970s film about hockey, part of which was filmed in nearby Johnstown. What was the name of the film?

Slap Shot. In the movie, the town was called Charleston.

In what 1942 movie do both John Wayne and Randolph Scott fall in love with Marlene Dietrich?

Pittsburgh. In the movie, Wayne’s nickname is “Pittsburgh.” After Wayne ditches his bride-to-be on the night of the wedding and tries to rekindle an affair with Dietrich, she slaps him in the face.

LIBRARIES



How many free libraries did Andrew Carnegie donate to the world?

2,509. He donated \$56,162,622 for construction of the libraries, but nothing for their upkeep.

What are the most frequently asked questions at the Carnegie Library’s Ready Reference Center?

- 1. Who are the tallest and shortest presidents?*
- 2. Who are the members of the U.S. Supreme Court?*
- 3. When was the “H” added to Pittsburgh?*
- 4. What are the words to the Twelve Days of Christmas?*



COLLEGES & UNIVERSITIES

How many nationality rooms are there at the University of Pittsburgh?

26, all of them located in the Cathedral of Learning. The rooms were started in 1938, and the first rooms were Swedish, Scottish, German, Russian, and Early American. The most recent room is Indian and was added in 2000.

They are used in e-mail all over the world now, but Carnegie Mellon University researcher, Scott Fahlman, typed the first one on September 19, 1982. What are they?

Emoticons.

The first one he posted was "smiley" or :-).



FLORA & FAUNA & THE GREAT OUTDOORS

How many different kinds of plants are in Phipps Conservatory's permanent collection?

Around 5,000. The figure varies due to acquisition and removals.

How many buffalo roam in Allegheny County's South Park?

Nine.



THE MISCELLANEOUS & THE MERELY STRANGE

From what European countries do the terms “nebbly” (nosey), and “yinz” (you all) originate?

Scotland and Ireland. There’s a chance “redd up” as in “redd up the house” has the same origin.

On average, how many visitors drop in at the Greater Pittsburgh Convention and Visitors Bureau information booth at Gateway Center each year?

28,000+.



Meeting “under the clock” presented a challenge on August 14, 1945—V-J Day. Courtesy Carnegie Library of Pittsburgh.

PLACES OF INTEREST

What is the diameter of Kaufmann’s clock? When was it built?

The bronze timepiece is six feet in diameter and was built around 1888. The Kaufmann brothers moved into the present location at Smithfield Street and Fifth Avenue in 1878. The structure at that location was built in 1913. Federated Department stores brought Kaufmann’s in 2005; it is being re-vamped as Macy’s.

What is downtown’s tallest building?

The USX Tower. It is 841 feet high.



MONEY, MONEY, MONEY

How much money did Allegheny County organizations receive from the National Endowment for the Arts in 2006?

\$193,000. The money went to nine different groups: The Mattress Factory (\$50,000), Children’s Museum of Pittsburgh (\$38,000), Pittsburgh Opera (\$35,000), Pittsburgh Ballet Theater (\$10,000), Pittsburgh Dance Alloy (\$10,000), Pittsburgh International Children’s Theater and Festival (\$10,000), Pittsburgh Cultural Trust (\$15,000), Squonk Opera (\$20,000), and the Creative Nonfiction Foundation (\$5,000). In 2004, the NEA gave \$152,100 to eight groups. In 1999, however, eighteen local groups received \$623,500 from the NEA.

From a dollar and cents standpoint, what is the economic impact of the arts locally?

Based on a 1998 survey, the arts community pumps \$170 million dollars directly into Allegheny County’s economy.

MEDIA & ADVERTISING

PEOPLE & PERSONALITIES



Who bid adieu to the viewers of his 11 p.m. newscast with “good night, good luck, and good news tomorrow”?

Former KDKA-TV anchor Bill Burns.

Which Pittsburgh television news anchor not only has an advanced degree in Asian studies, but also speaks a smattering of Japanese and Chinese?

WTAE's Sally Wiggin. Her Chinese name is Wei Shao-Li.



Paul Long (right) and “The Gunner” Bob Prince broadcasting a Bucs game. Courtesy Holly Van Dine.



In what date did Mister Rogers' Neighborhood first broadcast nationally on PBS?

February 19, 1968.

What do the letters in radio station WAMO stand for?

“W” is for east of the Mississippi River; “A” is for Allegheny; “M” for Monongahela; and “O” for Ohio.

ON AIR, PART II: THE VOICES OF SPORTS

How many hours was Myron Cope on the air with his WTAE-AM sports talk show?

A Pittsburgh Post-Gazette reporter estimated in 1994 that Cope spent about 7,500 hours on the air over his nearly 22 year career as a talk show host. Yoi! Cope retired entirely from broadcasting in 2005; who knows how many more hours he had accrued by then.

One of “The Gunner’s” broadcast partners was nicknamed after an animal. What was the partner’s real name and his nickname?

The “Gunner’s” partner was the “Possum,” Jim Woods.



IN PRINT

How many Pulitzer Prizes have been awarded to Pittsburgh newspaper reporters and photographers?

Eight. They are: 1938, Ray Sprigle (Pittsburgh Post-Gazette/Reporting); 1971, John Paul Filo (Tarentum, New Kensington Valley Daily News and Daily Dispatch/Photography); 1986, Andrew Schneider and Mary Pat Flaherty (Pittsburgh Press/Specialized Reporting); 1986, Andrew Schneider and Matthew Prellis (Pittsburgh Press/Meritorious Public Service); 1992, John Kaplan (Pittsburgh Post-Gazette/Photography); 1998 Martha Rial (Pittsburgh Post-Gazette/Photography).

On what day did the Pittsburgh Post-Gazette publish its first edition?

July 29, 1786. It was then known as the Pittsburgh Gazette. The paper was distributed around the Fort Pitt area.

PEOPLE FROM THE PAST



Nellie Bly made Phileus Fogg look like a slowpoke. Courtesy Carnegie Library of Pittsburgh.

Phileus Fogg, Jules Verne's character from *Around the World in Eighty Days* (1873), was a slacker compared to an investigative journalist born in Apollo, PA. In 1889-90 she traveled the world in 72 days, 6 hours, 11 minutes and 14 seconds. Who was she?

*Nellie Bly. Bly was born in Apollo in May, 1864. Her trip gave her worldwide fame. She started her newspaper career in Pittsburgh in 1885 and she died in 1922. She was born Elizabeth Cochran, but a newspaper editor suggested she take a pen name from a Stephen Foster song. The newspaper sponsoring her trip, *The New York World*, collected close to one million entries from readers trying to guess Bly's time.*

Only one ocean liner has had Pittsburgh in its name. When did the USS Pittsburgh first sail?

The USS Pittsburgh started her maiden voyage June 6, 1922 traveling from Liverpool to Boston. In 1926, her name was changed to Pennland II. In April, 1941, she was sunk by German bombers.

SLOGANS FOR SALE

What company's hamburger made you "happy to be hungry"?

Winky's. In its advertising, Winky's also boasted there was no Winky's in Wilmerding. Winky's was in business between the mid 1960s and the mid 1980s.

Aw, dry up!" could be interpreted as an impertinent injunction or it could be the slogan for a Pittsburgh-based company that began in 1949. Name the company.

It's Mariani and Richards, the waterproofing company. The slogan first appeared in a television commercial in 1952.





LAY OF THE LAND

How high did the water crest in the 1936 Saint Patrick's Day Pittsburgh flood?

At a record 46 feet.

Pittsburgh under water during the 1936 Saint Patrick's Day Flood. Photo by Frank E. Bingaman from the Stefan Lorant Iconography Collection. Courtesy of the Carnegie Library of Pittsburgh.

At the equator, the circumference of the earth is about 25,000 miles. Since it takes the earth 24 hours to make a complete revolution, that means at the equator the earth is spinning just over 1,000 miles per hour. How fast is the earth spinning at Pittsburgh's latitude, which is about 40 degrees north of the equator?

Someone standing at Pittsburgh's latitude would be traveling about 766 miles per hour. Locations of latitude further away from the equator move slower than 1,000 mph to make a revolution. To figure out the speed of the earth's rotation at Pittsburgh's latitude take the cosine of 40 degrees X 1,000.



During the winter of 1950-51, the weather outside was truly frightful. This photo was taken in December, 1950. Courtesy Carnegie Library of Pittsburgh.

GETTING FROM HERE TO THERE

How many bridges are in Allegheny County?

There are about 1,058 bridges in Allegheny County that are at least 20 feet in length, although no one knows the exact number because of conflicting databases maintained by various government agencies.

Whatever it is, it's a lot.

How many people land and take off from the Pittsburgh International Airport?

In 2005, 10.4+ million passengers landed and took off from Pittsburgh International Airport; 59% were USAirways passengers and 6% were Southwest. In 2004, 13.3 million passengers either got on or got off airplanes at the airport. USAirways accounted for 76 percent of the passengers. In 1999, 19.6 million passengers got on or off airplanes, and US Airways had 87% of the business.



FOOD (AND DRINK) FOR THOUGHT

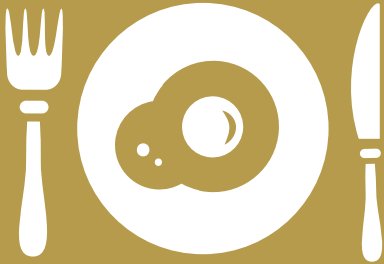

Where did McDonald's sell its first Big Mac?

The first worldwide sale of a Big Mac took place at McDonald's Uniontown store on Morgantown Street in 1968. It sold for 49¢. Jim Delligatti, a Pittsburgh McDonald's franchisee, invented the Big Mac.

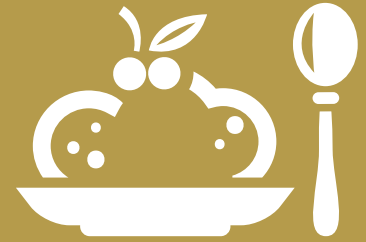

To a romanticist, Isaly's was more than a place to buy ice cream. What did the letters in Isaly's stand for?

Isaly's also stood for, "I shall always love you."

Where was the first Eat 'n Park located?

On Route 51 South, not too far from the Liberty Tunnels. The spot is now the location of another restaurant. The 13-seat store opened in 1949 with ten carhops. The second store opened in Avalon.

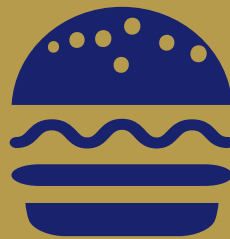

Don't hold the fries! Courtesy of Primanti Brothers Restaurant.

THE STADIUMS

(Or Stadia For You Purists)

How much did the Sony Jumbotron scoreboard and video display at the Mellon Arena weigh? How big was it and how much did it cost?

About 36,000 pounds. It cost \$34 million and has four, eight-foot by 10-foot screens. Each of the big screens is made up of 120 mini-screens. It was installed in 1995.



PUCKS. BALLS. BATS. JOCKS. PONIES. & ALL THAT OTHER STUFF

Did the Pirates win or lose the first game played at PNC Park?

They lost to the Reds, 8-2, on April 9, 2001.



BASEBALL

Batting helmets are now commonplace in baseball. In the 1950s they were less common than a no-hitter. What Pittsburgher helped to create the helmets?

It was Charlie Muse, a Pittsburgh Pirates executive for 52 years, serving as the team's traveling secretary for many of those years. Muse, along with two other men, designed a helmet for Branch Rickey, the Bucs' general manager. The Pirates were the first team to wear the helmets in 1952. Prior to plastic helmets a player's only protection was the cloth cap. Muse died in 2005.

BASKETBALL

Which Pitt Panther basketball players have:
The best career field goal percentage; the best career free throw percentage; the most career rebounds?

*Best field goal percentage career:
Brian Shorter (1988-91)—.538 percent.
Best free throw percentage career:
Sean Miller (1987-92)—.885 percent.
Most career rebounds:
Sam Clancy (1977-81)—1,342.*

FOOTBALL

PRO

Which former all-pro NFL quarterback was also a quarterback for Saint Justin High School in Pittsburgh and also for a semi-pro team in Pittsburgh, the Bloomfield Rams?

John Unitas.



FOOTBALL HIGH SCHOOL

What does "WPIAL" stand for and when was it formed?

The Western Pennsylvania Interscholastic Athletic League was formed in 1906. The league organizes and develops athletics for junior and senior high schools in Western Pennsylvania.

COLLEGE

This area college now competes in NCAA Division III football. In 1922, the school was in the Rose Bowl, the smallest school ever to be invited. What's the college's name?

Washington & Jefferson College. It played the University of California to a scoreless tie, the only scoreless tie in Rose Bowl history. Washington & Jefferson played with only 11 men and no substitutes.

GOLF

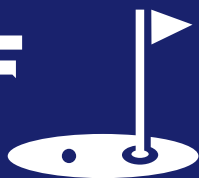

Name two of the four golfers who have won the West Penn Open and the U.S. Open. Naming all four is the trivia equivalent of a hole in one.

Sam Parks, Lew Worsham, Ed Furgol, Arnold Palmer.

HOCKEY



How long did it take for Mario Lemieux to score his first NHL goal?

It was first game, first shift, first shot and within 78 seconds he got his first goal. The year was 1984. After he came out of retirement in December 2000, he needed only 33 seconds into the game to get an assist on a goal by Jaromir Jagr.

BAIT 'N BULLETS



How big was the biggest fish ever caught in the Pittsburgh area?

The record belongs to Pittsburgher Seymore Abramovitz. In 1985, he caught a 43-pound, nine-ounce flathead catfish in the Allegheny River in Allegheny County.

HOCKEY



What were the Penguin colors before they were black and gold?

Dark blue, light blue and white. In 1980, the colors were changed to black and gold.



Ezzard Charles down for the count. Photo by James G. Klingensmith, 1951. Courtesy of the Carnegie Library of Pittsburgh. © Pittsburgh Post-Gazette.

& ALL THAT OTHER STUFF

Where and when was the last heavyweight championship boxing match in Pittsburgh? Who fought? Who won?

On July 18, 1951, Arnold Raymond Cream knocked out Ezzard Charles in seven rounds at Forbes Field to become world heavyweight champion. Boxing fans will know Cream as Jersey Joe Walcott.

GOVERNMENT & POLITICS

Why are all the fire hydrants within the city of Pittsburgh painted either red, yellow or green?

The colors indicate the size of the main waterlines that feed the hydrants. That way, firefighters know how much water pressure is at a hydrant. For example, green indicates a 24-inch line.



GOVERNMENT & POLITICS

After President Woodrow Wilson helped make the world safe for democracy in World War I, he and his attorney general, A. Mitchell Palmer, decided to keep the United States safe from communism. On January 2, 1920 the United States Department of Justice raided Communist party offices throughout America. Over 2,000 persons were arrested. How many were arrested in Pittsburgh?

There were 22 arrests made while a meeting was in progress on the third floor of the Communist Party of America district headquarters located at 1207 Fifth Avenue downtown. Russian literature and party membership cards were confiscated. Another 16 arrests were made in Youngstown, Ohio. The Wilson campaign against communism became known as the "Red Scare."

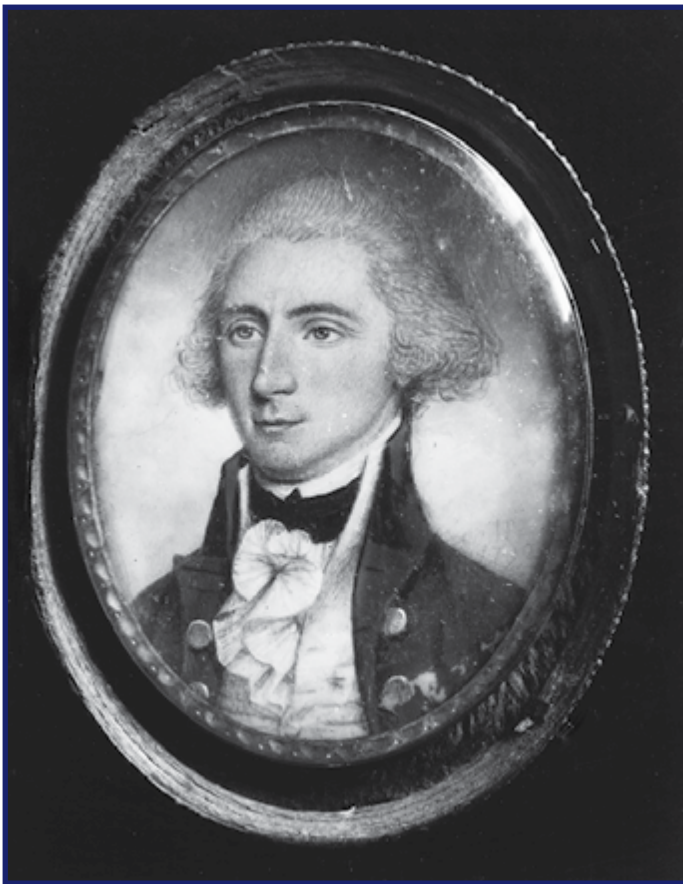

*Pittsburgh's first Hizzoner, Ebenezer Denny.
Courtesy of the Carnegie Library of Pittsburgh.*



*Volunteers prepare Meals on Wheels in Avonworth.
Courtesy of The Lutheran Service Society.*

WHO WE ARE

In an average year, how many meals does the Lutheran Service Society of Western Pennsylvania's Meals on Wheels program distribute?

Meals on Wheels distributes about 1.2 million meals annually in Allegheny County. In the tri-state area, they pass out about 2.3 million meals a year.

& HOW WE LIVE

The Make-A-Wish Foundation of Western Pennsylvania grants wishes to children facing a life-threatening illness. When did Make-A-Wish make its first wish and what was it?

In May 1983, Make-A-Wish flew Bryan McClinton to Texas to visit his uncle because the uncle gave Bryan the best piggy-back ride. From 1983 to mid 2005, Make-A-Wish has granted nearly 7,000 wishes.

How many Mr. Yuk stickers have been distributed throughout the world by the Pittsburgh Poison Control Center?

Over 900 million stickers.



Yum! Yum!



BUSINESS IN THE , BURGH

Who was Pittsburgh's first millionaire?

John N. Ingham, in his book Making Iron and Steel says it was perhaps Curtis G. Hussey. Hussey was born in York, PA and started his professional career as a physician. He left his practice to open a general store in Western Pennsylvania where he also began dealing in pork. Eventually, he invested in a copper mine in the Lake Superior region and became a copper manufacturer. Ingham claims that Hussey was "perhaps" a millionaire by the time of the Civil War.

BUSINESS IN THE , BURGH

At one time, what did it mean to be "Westinghoused"?

It meant to be electrocuted. In the early 1900s, there was a debate over whether direct current (DC) or alternating current (AC) was the safer way to deliver electricity. Thomas Edison favored DC, Pittsburgher George Westinghouse favored AC. Edison came up with the term to describe the fate of someone who had been executed by the electric chair. Needless to say, the Pittsburgher won.



BEYOND THE BURG

How long is Altoona's horseshoe curve and what is it?

The semi-circle curve is about 1,400 feet across and its arc is nearly one mile long. It opened in 1854 and was built using picks, shovels and horses. The curve was built by the Pennsylvania Railroad.

When and where did America's deadliest flash flood occur?

The day was May 31, 1889. A 72 foot high, 930-foot dam broke about 24 miles from Johnstown, PA. At one point, the water hit a height of 76 feet. The death toll was 2,209. The dam, which was built in 1852, was in a state of disrepair even though some repairs had been made to it.

